

7-31-2019 Drawing 15

Designed by: Tyler Ponko  
 Certified Playground Safety Inspector

**BEST AGES 6-23 months, 5-12 years, 2-12 years**

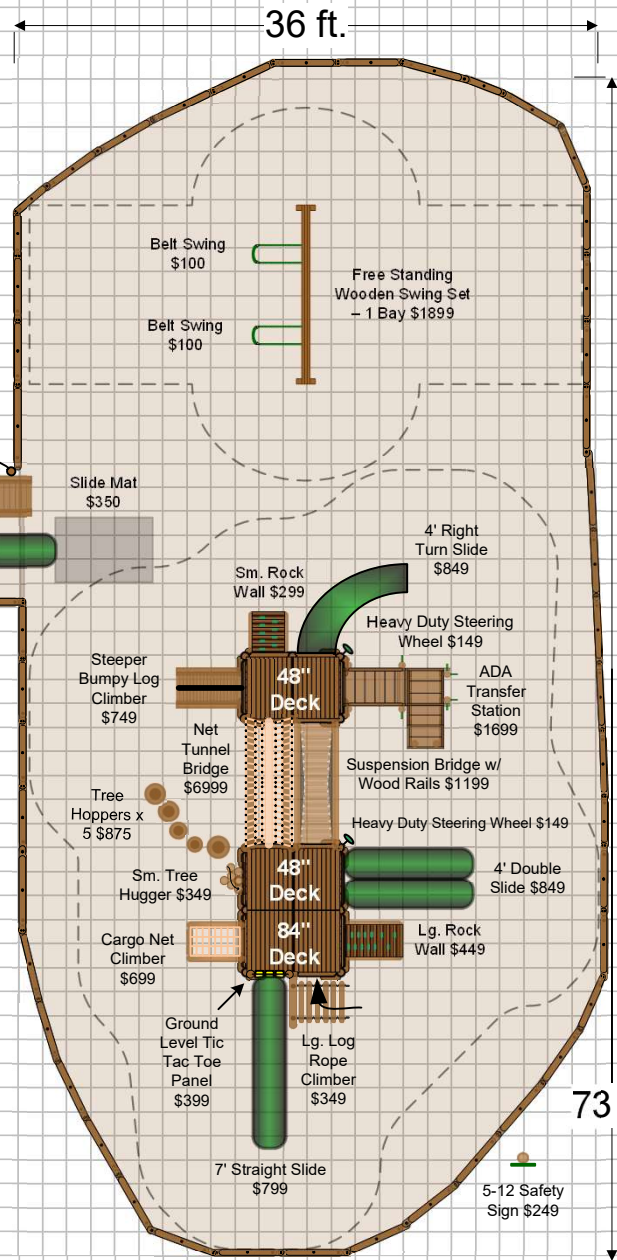
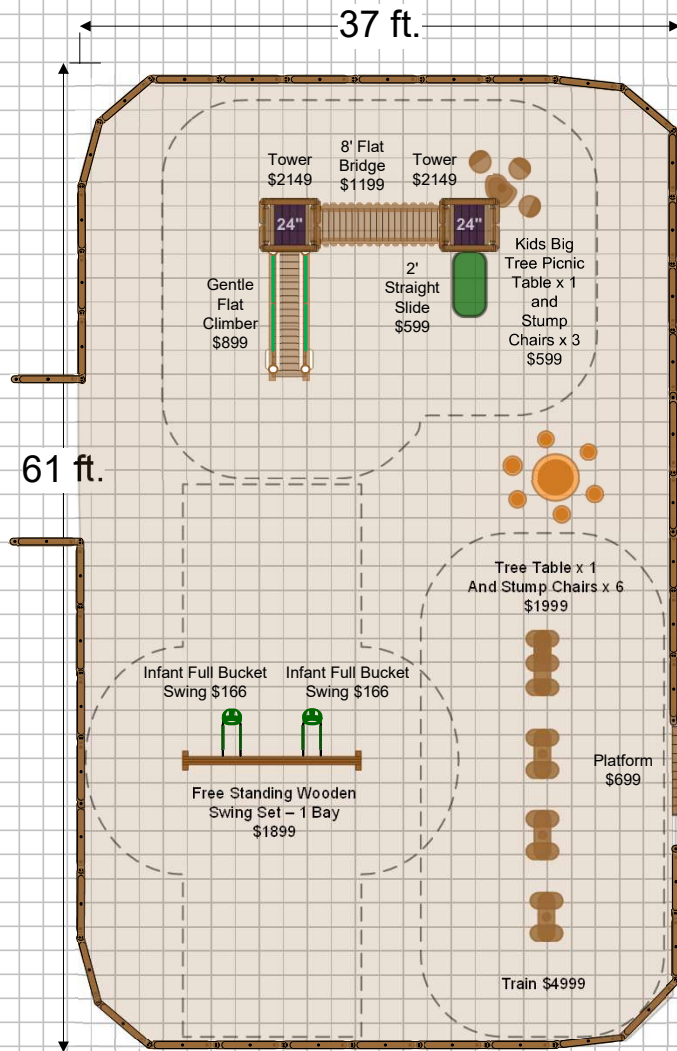

**ALL DESIGNS ARE CUSTOMIZABLE!!**  
 Parts can be added, removed and shifted around.

Ask about our safety surfacing package that can include wooden or rubber mulch with barrier fabric and a containment border.



Tracy City Old Roundhouse Park  
663 Railroad Ave  
Tracy City, TN 37387



Designed by: Tyler Ponko  
Certified Playground Safety Inspector

7-31-2019 Drawing 15

Little Lumber Jack Village, Swiss Tree Fort,  
Independent Play

**BEST AGES 6-23 months, 5-12 years,  
2-12 years**

| <b>LITTLE LUMBERJACK VILLAGE</b>                                                                                                                     |                     | OPTIONAL EXCLUDED |
|------------------------------------------------------------------------------------------------------------------------------------------------------|---------------------|-------------------|
| TOWER                                                                                                                                                | 2149                |                   |
| TOWER                                                                                                                                                | 2149                |                   |
| FLAT BRIDGE                                                                                                                                          | 1199                |                   |
| GENTLE FLAT CLIMBER                                                                                                                                  | 899                 |                   |
| 2' STRAIGHT SLIDE                                                                                                                                    | 599                 |                   |
| BIG TREE TABLE AND CHAIRS X 3                                                                                                                        | 599                 | \$ 7,594          |
| <b>SWISS TREE FORT VILLAGE</b>                                                                                                                       |                     | OPTIONAL EXCLUDED |
| PROUDEST MONKEY STRUCTURE 1                                                                                                                          | 3499                |                   |
| PONDEROSA STRUCTURE 2                                                                                                                                | 5499                |                   |
| SUSPENSION BRIDGE W/ RAILS                                                                                                                           | 1199                |                   |
| NET TUNNEL BRIDGE                                                                                                                                    | 6999                |                   |
| WOODEN RAIL OPTION X 0                                                                                                                               | n/a                 |                   |
| WOODEN ROOF OPTION X 3                                                                                                                               | 1197                |                   |
| SAFETY SIGN X 1                                                                                                                                      | 249                 |                   |
| <b>ON STRUCTURE 1</b>                                                                                                                                |                     |                   |
| 4' RIGHT TURN SLIDE                                                                                                                                  | 849                 |                   |
| SM ROCK WALL                                                                                                                                         | 299                 |                   |
| STEEPER BUMPY LOG CLIMBER                                                                                                                            | 749                 |                   |
| ADA TRANSFER STATION                                                                                                                                 | 1699                |                   |
| HEAVY DUTY STEERING WHEEL                                                                                                                            | 149                 |                   |
| <b>ON STRUCTURE 2</b>                                                                                                                                |                     |                   |
| HEAVY DUTY STEERING WHEEL                                                                                                                            | 149                 |                   |
| TREE HOPPERS X 5                                                                                                                                     | 875                 |                   |
| SM TREE HUGGER                                                                                                                                       | 349                 |                   |
| CARGO NET CLIMBER                                                                                                                                    | 699                 |                   |
| GL TIC TAC TOE PANEL                                                                                                                                 | 399                 |                   |
| 7' STRAIGHT SLIDE                                                                                                                                    | 799                 |                   |
| LG LOG ROPE CLIMBER                                                                                                                                  | 349                 |                   |
| LG ROCK WALL                                                                                                                                         | 449                 |                   |
| 4' DOUBLE SLIDE                                                                                                                                      | 849                 | \$ 27,304         |
| <b>INDEPENDENT PLAY</b>                                                                                                                              |                     | OPTIONAL EXCLUDED |
| PLATFORM                                                                                                                                             | 699                 |                   |
| GENTLE BUMPY LOG CLIMBER                                                                                                                             | 949                 |                   |
| 7' STRAIGHT SLIDE                                                                                                                                    | 799                 |                   |
| SLIDE MAT                                                                                                                                            | 350                 |                   |
| FS WOODEN SWING SET 1 BAY                                                                                                                            | 1899                |                   |
| BELT SWING X 2                                                                                                                                       | 200                 |                   |
| FS WOODEN SWING SET 1 BAY                                                                                                                            | 1899                |                   |
| INFANT FULL BUCKET SWING X 2                                                                                                                         | 332                 |                   |
| TREE TABLE AND STUMP CHAIRS X 6                                                                                                                      | 1999                |                   |
| CUSTOM TRAIN                                                                                                                                         | 4999                | \$ 14,125         |
| <b>SUB TOTAL</b>                                                                                                                                     | <b>\$ 49,023.00</b> |                   |
| SHIPPING ESTIMATE / MOBILIZATION                                                                                                                     | ???                 |                   |
| INSTALL BY BEARS                                                                                                                                     | ???                 |                   |
| <b>SAFETY SURFACING PACKAGE</b>                                                                                                                      |                     |                   |
| CERT. WOODEN MULCH- ? YDS^3                                                                                                                          | ?                   |                   |
| BARRIER FABRIC- ? FT^2                                                                                                                               | ?                   |                   |
| DOUBLE HIGH LOG BORDERS X ?                                                                                                                          | ?                   |                   |
| HEAVY DUTY Swing/Slide Mat X ?                                                                                                                       | ?                   |                   |
| SURFACING PACKAGE INSTALL                                                                                                                            | ?                   |                   |
| NEW TOTAL                                                                                                                                            | ????                |                   |
| SALES TAX                                                                                                                                            |                     |                   |
| <b>GRAND TOTAL</b>                                                                                                                                   | <b>\$ -</b>         |                   |
| ADA Compliant & Certified Safety Surfacing available upon request.<br>Specifications, product offerings & prices are subject to change w/out notice. |                     |                   |
| <b>INSTALL AND SHIPPING PRICES SUBJECT TO CHANGE</b>                                                                                                 |                     |                   |



7577 E. Main St, Lima NY 14485  
 877-807-7529 (p) 585-624-7590 (f)  
 info@bearsplaygrounds.com

Tracy City Old Roundhouse  
 Park  
 663 Railroad Ave  
 Tracy City, TN 37387



CPSC now recommends a minimum of 9" of loose fill safety surfacing material be installed and maintained in the use zone for safety. Safety surfacing package is to be "by others" unless specially included for an optional extra charge at the time of order. Acceptance of this proposal means that you accept Bears Playgrounds terms and conditions as described on the web site [www.bearsplaygrounds.com](http://www.bearsplaygrounds.com)

The Americans with Disabilities Act (ADA) may require that you make your park and / or playground accessible when viewed in it's entirety. Please consult your legal counsel to determine if the ADA applies to you. For playground equipment to be considered accessible, accessible surfacing must be utilized in applicable areas. Although a particular playground design may not meet the proposed Access Board Regulations in regards to the appropriate number of ground level events, the actual playground may be in compliance when considering existing play components.

Not all equipment may be appropriate for all children, even when designed for a target age group. To avoid injury you should closely supervise and participate in the child's use of this equipment, especially while learning to use it. Proper supervision is required.



Designed by: Tyler Ponko  
 Certified Playground Safety Inspector

7-31-2019 Drawing 15

Little Lumber Jack Village, Swiss Tree Fort,  
 Independent Play

**BEST AGES 6-23 months, 5-12  
 years, 2-12 years**



7577 E. Main St, Lima NY 14485  
 877-807-7529 (p) 585-624-7590 (f)  
 info@bearsplaygrounds.com

Tracy City Old Roundhouse  
 Park  
 663 Railroad Ave  
 Tracy City, TN 37387



CPSC now recommends a minimum of 9" of loose fill safety surfacing material be installed and maintained in the use zone for safety. Safety surfacing package is to be "by others" unless specially included for an optional extra charge at the time of order. Acceptance of this proposal means that you accept Bears Playgrounds terms and conditions as described on the web site [www.bearsplaygrounds.com](http://www.bearsplaygrounds.com)

The Americans with Disabilities Act (ADA) may require that you make your park and / or playground accessible when viewed in it's entirety. Please consult your legal counsel to determine if the ADA applies to you. For playground equipment to be considered accessible, accessible surfacing must be utilized in applicable areas. Although a particular playground design may not meet the proposed Access Board Regulations in regards to the appropriate number of ground level events, the actual playground may be in compliance when considering existing play components.

Not all equipment may be appropriate for all children, even when designed for a target age group. To avoid injury you should closely supervise and participate in the child's use of this equipment, especially while learning to use it. Proper supervision is required.



Designed by: Tyler Powko  
 Certified Playground Safety Inspector

7-31-2019 Drawing 15

Little Lumber Jack Village, Swiss Tree Fort,  
 Independent Play

**BEST AGES 6-23 months, 5-12  
 years, 2-12 years**



7577 E. Main St, Lima NY 14485  
 877-807-7529 (p) 585-624-7590 (f)  
 info@bearsplaygrounds.com

Tracy City Old Roundhouse  
 Park  
 663 Railroad Ave  
 Tracy City, TN 37387



CPSC now recommends a minimum of 9" of loose fill safety surfacing material be installed and maintained in the use zone for safety. Safety surfacing package is to be "by others" unless specially included for an optional extra charge at the time of order. Acceptance of this proposal means that you accept Bears Playgrounds terms and conditions as described on the web site [www.bearsplaygrounds.com](http://www.bearsplaygrounds.com)

The Americans with Disabilities Act (ADA) may require that you make your park and / or playground accessible when viewed in it's entirety. Please consult your legal counsel to determine if the ADA applies to you. For playground equipment to be considered accessible, accessible surfacing must be utilized in applicable areas. Although a particular playground design may not meet the proposed Access Board Regulations in regards to the appropriate number of ground level events, the actual playground may be in compliance when considering existing play components.

Not all equipment may be appropriate for all children, even when designed for a target age group. To avoid injury you should closely supervise and participate in the child's use of this equipment, especially while learning to use it. Proper supervision is required.



Designed by: Tyler Powko  
 Certified Playground Safety Inspector

7-31-2019 Drawing 15

Little Lumber Jack Village, Swiss Tree Fort,  
 Independent Play

**BEST AGES 6-23 months, 5-12 years, 2-12 years**



7577 E. Main St, Lima NY 14485  
 877-807-7529 (p) 585-624-7590 (f)  
 info@bearsplaygrounds.com

Tracy City Old Roundhouse  
 Park  
 663 Railroad Ave  
 Tracy City, TN 37387



CPSC now recommends a minimum of 9" of loose fill safety surfacing material be installed and maintained in the use zone for safety. Safety surfacing package is to be "by others" unless specially included for an optional extra charge at the time of order. Acceptance of this proposal means that you accept Bears Playgrounds terms and conditions as described on the web site [www.bearsplaygrounds.com](http://www.bearsplaygrounds.com)

The Americans with Disabilities Act (ADA) may require that you make your park and / or playground accessible when viewed in it's entirety. Please consult your legal counsel to determine if the ADA applies to you. For playground equipment to be considered accessible, accessible surfacing must be utilized in applicable areas. Although a particular playground design may not meet the proposed Access Board Regulations in regards to the appropriate number of ground level events, the actual playground may be in compliance when considering existing play components.

Not all equipment may be appropriate for all children, even when designed for a target age group. To avoid injury you should closely supervise and participate in the child's use of this equipment, especially while learning to use it. Proper supervision is required.



Designed by: Tyler Powko  
 Certified Playground Safety Inspector

7-31-2019 Drawing 15

Little Lumber Jack Village, Swiss Tree Fort,  
 Independent Play

**BEST AGES 6-23 months, 5-12  
 years, 2-12 years**



7577 E. Main St, Lima NY 14485  
 877-807-7529 (p) 585-624-7590 (f)  
 info@bearsplaygrounds.com

Tracy City Old Roundhouse  
 Park  
 663 Railroad Ave  
 Tracy City, TN 37387



CPSC now recommends a minimum of 9" of loose fill safety surfacing material be installed and maintained in the use zone for safety. Safety surfacing package is to be "by others" unless specially included for an optional extra charge at the time of order. Acceptance of this proposal means that you accept Bears Playgrounds terms and conditions as described on the web site [www.bearsplaygrounds.com](http://www.bearsplaygrounds.com)

The Americans with Disabilities Act (ADA) may require that you make your park and / or playground accessible when viewed in it's entirety. Please consult your legal counsel to determine if the ADA applies to you. For playground equipment to be considered accessible, accessible surfacing must be utilized in applicable areas. Although a particular playground design may not meet the proposed Access Board Regulations in regards to the appropriate number of ground level events, the actual playground may be in compliance when considering existing play components.

Not all equipment may be appropriate for all children, even when designed for a target age group. To avoid injury you should closely supervise and participate in the child's use of this equipment, especially while learning to use it. Proper supervision is required.



Designed by: Tyler Ponko  
 Certified Playground Safety Inspector

7-31-2019 Drawing 15

Little Lumber Jack Village, Swiss Tree Fort,  
 Independent Play

**BEST AGES 6-23 months, 5-12 years, 2-12 years**



7577 E. Main St, Lima NY 14485  
 877-807-7529 (p) 585-624-7590 (f)  
 info@bearsplaygrounds.com

Tracy City Old Roundhouse  
 Park  
 663 Railroad Ave  
 Tracy City, TN 37387



CPSC now recommends a minimum of 9" of loose fill safety surfacing material be installed and maintained in the use zone for safety. Safety surfacing package is to be "by others" unless specially included for an optional extra charge at the time of order. Acceptance of this proposal means that you accept Bears Playgrounds terms and conditions as described on the web site [www.bearsplaygrounds.com](http://www.bearsplaygrounds.com)

The Americans with Disabilities Act (ADA) may require that you make your park and / or playground accessible when viewed in it's entirety. Please consult your legal counsel to determine if the ADA applies to you. For playground equipment to be considered accessible, accessible surfacing must be utilized in applicable areas. Although a particular playground design may not meet the proposed Access Board Regulations in regards to the appropriate number of ground level events, the actual playground may be in compliance when considering existing play components.

Not all equipment may be appropriate for all children, even when designed for a target age group. To avoid injury you should closely supervise and participate in the child's use of this equipment, especially while learning to use it. Proper supervision is required.



Designed by: Tyler Ponko  
 Certified Playground Safety Inspector

7-31-2019 Drawing 15

Little Lumber Jack Village, Swiss Tree Fort,  
 Independent Play

**BEST AGES 6-23 months, 5-12 years, 2-12 years**





7577 E. Main St, Lima NY 14485  
 877-807-7529 (p) 585-624-7590 (f)  
 info@bearsplaygrounds.com

Tracy City Old Roundhouse  
 Park  
 663 Railroad Ave  
 Tracy City, TN 37387



CPSC now recommends a minimum of 9" of loose fill safety surfacing material be installed and maintained in the use zone for safety. Safety surfacing package is to be "by others" unless specially included for an optional extra charge at the time of order. Acceptance of this proposal means that you accept Bears Playgrounds terms and conditions as described on the web site [www.bearsplaygrounds.com](http://www.bearsplaygrounds.com)

The Americans with Disabilities Act (ADA) may require that you make your park and / or playground accessible when viewed in it's entirety. Please consult your legal counsel to determine if the ADA applies to you. For playground equipment to be considered accessible, accessible surfacing must be utilized in applicable areas. Although a particular playground design may not meet the proposed Access Board Regulations in regards to the appropriate number of ground level events, the actual playground may be in compliance when considering existing play components.

Not all equipment may be appropriate for all children, even when designed for a target age group. To avoid injury you should closely supervise and participate in the child's use of this equipment, especially while learning to use it. Proper supervision is required.

|  |  |  |  |
|--|--|--|--|
|  |  |  |  |
|--|--|--|--|

Designed by: Tyler Ponko  
 Certified Playground Safety Inspector

7-31-2019 Drawing 15

Little Lumber Jack Village, Swiss Tree Fort,  
 Independent Play

**BEST AGES 6-23 months, 5-12  
 years, 2-12 years**



7577 E. Main St, Lima NY 14485  
 877-807-7529 (p) 585-624-7590 (f)  
 info@bearsplaygrounds.com

Tracy City Old Roundhouse  
 Park  
 663 Railroad Ave  
 Tracy City, TN 37387



CPSC now recommends a minimum of 9" of loose fill safety surfacing material be installed and maintained in the use zone for safety. Safety surfacing package is to be "by others" unless specially included for an optional extra charge at the time of order. Acceptance of this proposal means that you accept Bears Playgrounds terms and conditions as described on the web site [www.bearsplaygrounds.com](http://www.bearsplaygrounds.com)

The Americans with Disabilities Act (ADA) may require that you make your park and / or playground accessible when viewed in it's entirety. Please consult your legal counsel to determine if the ADA applies to you. For playground equipment to be considered accessible, accessible surfacing must be utilized in applicable areas. Although a particular playground design may not meet the proposed Access Board Regulations in regards to the appropriate number of ground level events, the actual playground may be in compliance when considering existing play components.

Not all equipment may be appropriate for all children, even when designed for a target age group. To avoid injury you should closely supervise and participate in the child's use of this equipment, especially while learning to use it. Proper supervision is required.

|  |  |  |  |
|--|--|--|--|
|  |  |  |  |
|--|--|--|--|

Designed by: Tyler Ponko  
 Certified Playground Safety Inspector

7-31-2019 Drawing 15

Little Lumber Jack Village, Swiss Tree Fort,  
 Independent Play

**BEST AGES 6-23 months, 5-12  
 years, 2-12 years**

custom. nature inspired. cedar log playgrounds.



**BEARS**   
bearsplaygrounds.com



Bears Playgrounds' nature-inspired products and natural materials help stimulate a child's imagination and enthusiasm for outdoor play. Their products facilitate learning, help build social skills, create opportunities for exercise, and by virtue of unique designs and materials, provide children with a connection to nature.

Bears Playgrounds' products are strong and durable, however, **there are natural aesthetics of real log products of which you should be aware.** Cedar logs have a fat end and a skinny end like a tree (instead of a manufactured dowel), **they have gorgeous wood grain, checking, knots, crooks, grooves, curves, even the occasional stubborn piece of bark, etc.** Those who are familiar with log construction know that it is subject to the natural process of "checking".



**Checking, or cracks, occur across or through the growth rings as they release moisture.** This is a natural process and is common to all wood species. Checking is not a defect in the wood; it does not diminish the quality, durability, safety, or the structural integrity. Instead, it is considered a part of the log's rustic natural look and adds to the uniqueness of each piece.

Your products will have checking!

We want to ensure your satisfaction with these nature-inspired products. Please call us with any questions, suggestions, or concerns.

877-807-7529

info@bearsplaygrounds.com