



7577 E. Main St, Lima NY 14485  
877-807-7529 (p) 585-624-7590 (f)  
info@bearsplaygrounds.com

Brandon, SD 57005

Attn: Contact Name  
E-Mail  
Phone #  
Alternate

Additional Contact

CPSC now recommends a minimum of 9" of loose fill safety surfacing material be installed and maintained in the use zone for safety. Safety surfacing package is to be "by others" unless specially included for an optional extra charge at the time of order. Acceptance of this proposal means that you accept Bears Playgrounds terms and conditions as described on the web site [www.bearsplaygrounds.com](http://www.bearsplaygrounds.com)

The Americans with Disabilities Act (ADA) may require that you make your park and / or playground accessible when viewed in it's entirety. Please consult your legal counsel to determine if the ADA applies to you. For playground equipment to be considered accessible, accessible surfacing must be utilized in applicable areas. Although a particular playground design may not meet the proposed Access Board Regulations in regards to the appropriate number of ground level events, the actual playground may be in compliance when considering existing play components.

Not all equipment may be appropriate for all children, even when designed for a target age group. To avoid injury you should closely supervise and participate in the child's use of this equipment, especially while learning to use it. Proper supervision is required.

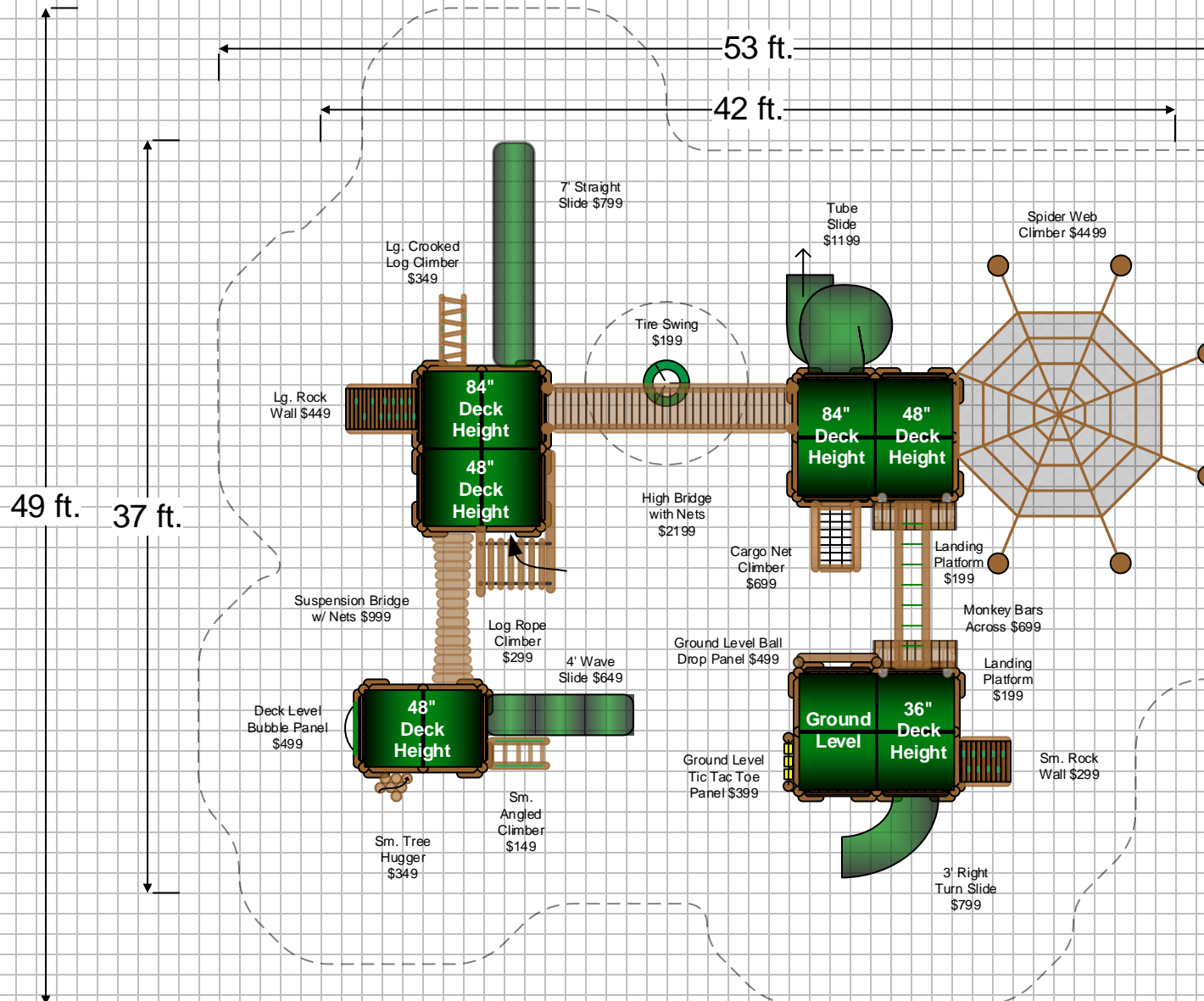

Ask about our safety surfacing package that can include wooden or rubber mulch with barrier fabric and a containment border.

**ALL DESIGNS ARE CUSTOMIZABLE!!**

Parts can be added, removed and shifted around.

Designed by: *Trey Socash*  
Certified Playground Safety Inspector

6-28-2019 Drawing 4

Danny's Love, Life, Adventure

**RESIDENTIAL**



7577 E. Main St, Lima NY 14485  
877-807-7529 (p) 585-624-7590 (f)  
info@bearsplaygrounds.com

Brandon, SD 57005

Attn: Contact Name

E-Mail

Phone #

Alternate

Additional Contact

**ALL DESIGNS ARE  
CUSTOMIZABLE!!**

Parts can be added, removed  
and shifted around.

Ask about our safety  
surfacing package that  
can include wooden or  
rubber mulch with barrier  
fabric and a containment  
border.

**DANNY'S LOVE, LOVE, ADVENTURE**

OPTIONAL  
EXCLUDED

PROUDEST MONKEY STRUCTURE 1	2499	
PONDEROSA STRUCTURE 2	3499	
PONDEROSA STRUCTURE 3	3499	
COWBOY UP STRUCTURE 4	2999	
MONKEY BARS ACROSS	699	
SUSPENSION BRIDGE W/ NETS	999	
HIGH BRIDGE W/ NETS	2199	
TIRE SWING	199	
WOODEN RAIL X 11	825	
WOODEN ROOF X 7	not included	2793

**ON STRUCTURE 1**

DECK LEVEL BUBBLE PANEL	499	
SM TREE HUGGER	349	
ANGLED CLIMBER	149	
4' WAVE SLIDE	649	

**ON STRUCTURE 2**

7' TORPEDO STRAIGHT SLIDE	799	
LG CROOKED LOG CLIMBER	349	
LG ROCK WALL	449	
LOG ROPE CLIMBER	299	

**ON STRUCTURE 3**

8' SPIDER WEB CLIMBER	4499	
TUBE SLIDE	1199	
CARGO NET CLIMBER	699	
LANDING PLATFORM	199	

**ON STRUCTURE 4**

LANDING PLATFORM	199	
GROUND LEVEL BALL DROP	499	
GROUND LEVEL TIC TAC TOE	399	
ANGLED CLIMBER	100	
3' RIGHT TURN SLIDE	799	
SM ROCK WALL	299	

SUB TOTAL **\$29,850.00**

SHIPPING ESTIMATE / MOBILIZATION ???

INSTALL BY BEARS ???

**SAFETY SURFACING PACKAGE**  
CERT. WOODEN MULCH- ? YDS<sup>3</sup>  
BARRIER FABRIC- ? FT<sup>2</sup>  
DOUBLE HIGH LOG BORDERS X ?  
HEAVY DUTY Swing/Slide Mat X ?  
SURFACING PACKAGE INSTALL

NOT YET  
INCLUDED-  
AVAILABLE  
UPON  
REQUEST

NEW TOTAL ???

SALES TAX

**GRAND TOTAL**

ADA Compliant & Certified Safety Surfacing available upon request.

Specifications, product offerings & prices are subject to change w/out notice.

**INSTALL AND SHIPPING PRICES SUBJECT TO CHANGE**

Designed by: Trey Socash  
Certified Playground Safety Inspector

6-28-2019 Drawing 4

Danny's Love, Life,  
Adventure

**RESIDENTIAL**



7577 E. Main St, Lima NY 14485  
877-807-7529 (p) 585-624-7590 (f)  
info@bearsplaygrounds.com

Brandon, SD 57005

Attn: Contact Name  
E-Mail  
Phone #  
Alternate

Additional Contact

CPSC now recommends a minimum of 9" of loose fill safety surfacing material be installed and maintained in the use zone for safety. Safety surfacing package is to be "by others" unless specially included for an optional extra charge at the time of order. Acceptance of this proposal means that you accept Bears Playgrounds terms and conditions as described on the web site [www.bearsplaygrounds.com](http://www.bearsplaygrounds.com)

The Americans with Disabilities Act (ADA) may require that you make your park and / or playground accessible when viewed in it's entirety. Please consult your legal counsel to determine if the ADA applies to you. For playground equipment to be considered accessible, accessible surfacing must be utilized in applicable areas. Although a particular playground design may not meet the proposed Access Board Regulations in regards to the appropriate number of ground level events, the actual playground may be in compliance when considering existing play components.

Not all equipment may be appropriate for all children, even when designed for a target age group. To avoid injury you should closely supervise and participate in the child's use of this equipment, especially while learning to use it. Proper supervision is required.



Designed by: Trey Socash  
Certified Playground Safety Inspector

6-28-2019 Drawing 4

Danny's Love, Life, Adventure

**RESIDENTIAL**





7577 E. Main St, Lima NY 14485  
877-807-7529 (p) 585-624-7590 (f)  
info@bearsplaygrounds.com

Brandon, SD 57005

Attn: Contact Name  
E-Mail  
Phone #  
Alternate

Additional Contact

CPSC now recommends a minimum of 9" of loose fill safety surfacing material be installed and maintained in the use zone for safety. Safety surfacing package is to be "by others" unless specially included for an optional extra charge at the time of order. Acceptance of this proposal means that you accept Bears Playgrounds terms and conditions as described on the web site [www.bearsplaygrounds.com](http://www.bearsplaygrounds.com)

The Americans with Disabilities Act (ADA) may require that you make your park and / or playground accessible when viewed in it's entirety. Please consult your legal counsel to determine if the ADA applies to you. For playground equipment to be considered accessible, accessible surfacing must be utilized in applicable areas. Although a particular playground design may not meet the proposed Access Board Regulations in regards to the appropriate number of ground level events, the actual playground may be in compliance when considering existing play components.

Not all equipment may be appropriate for all children, even when designed for a target age group. To avoid injury you should closely supervise and participate in the child's use of this equipment, especially while learning to use it. Proper supervision is required.



Designed by: Trey Socash  
Certified Playground Safety Inspector

6-28-2019 Drawing 4

Danny's Love, Life, Adventure

**RESIDENTIAL**





7577 E. Main St, Lima NY 14485  
877-807-7529 (p) 585-624-7590 (f)  
info@bearsplaygrounds.com

Brandon, SD 57005

Attn: Contact Name  
E-Mail  
Phone #  
Alternate

Additional Contact

CPSC now recommends a minimum of 9" of loose fill safety surfacing material be installed and maintained in the use zone for safety. Safety surfacing package is to be "by others" unless specially included for an optional extra charge at the time of order. Acceptance of this proposal means that you accept Bears Playgrounds terms and conditions as described on the web site [www.bearsplaygrounds.com](http://www.bearsplaygrounds.com)

The Americans with Disabilities Act (ADA) may require that you make your park and / or playground accessible when viewed in it's entirety. Please consult your legal counsel to determine if the ADA applies to you. For playground equipment to be considered accessible, accessible surfacing must be utilized in applicable areas. Although a particular playground design may not meet the proposed Access Board Regulations in regards to the appropriate number of ground level events, the actual playground may be in compliance when considering existing play components.

Not all equipment may be appropriate for all children, even when designed for a target age group. To avoid injury you should closely supervise and participate in the child's use of this equipment, especially while learning to use it. Proper supervision is required.



Designed by: Trey Socash  
Certified Playground Safety Inspector

6-28-2019 Drawing 4

Danny's Love, Life, Adventure

**RESIDENTIAL**





7577 E. Main St, Lima NY 14485  
877-807-7529 (p) 585-624-7590 (f)  
info@bearsplaygrounds.com

Brandon, SD 57005

Attn: Contact Name  
E-Mail  
Phone #  
Alternate

Additional Contact

CPSC now recommends a minimum of 9" of loose fill safety surfacing material be installed and maintained in the use zone for safety. Safety surfacing package is to be "by others" unless specially included for an optional extra charge at the time of order. Acceptance of this proposal means that you accept Bears Playgrounds terms and conditions as described on the web site [www.bearsplaygrounds.com](http://www.bearsplaygrounds.com)

The Americans with Disabilities Act (ADA) may require that you make your park and / or playground accessible when viewed in it's entirety. Please consult your legal counsel to determine if the ADA applies to you. For playground equipment to be considered accessible, accessible surfacing must be utilized in applicable areas. Although a particular playground design may not meet the proposed Access Board Regulations in regards to the appropriate number of ground level events, the actual playground may be in compliance when considering existing play components.

Not all equipment may be appropriate for all children, even when designed for a target age group. To avoid injury you should closely supervise and participate in the child's use of this equipment, especially while learning to use it. Proper supervision is required.



Designed by: Trey Socash  
Certified Playground Safety Inspector

6-28-2019 Drawing 4

Danny's Love, Life, Adventure

**RESIDENTIAL**





7577 E. Main St, Lima NY 14485  
877-807-7529 (p) 585-624-7590 (f)  
info@bearsplaygrounds.com

Brandon, SD 57005

Attn: Contact Name  
E-Mail  
Phone #  
Alternate

Additional Contact

CPSC now recommends a minimum of 9" of loose fill safety surfacing material be installed and maintained in the use zone for safety. Safety surfacing package is to be "by others" unless specially included for an optional extra charge at the time of order. Acceptance of this proposal means that you accept Bears Playgrounds terms and conditions as described on the web site [www.bearsplaygrounds.com](http://www.bearsplaygrounds.com)

The Americans with Disabilities Act (ADA) may require that you make your park and / or playground accessible when viewed in it's entirety. Please consult your legal counsel to determine if the ADA applies to you. For playground equipment to be considered accessible, accessible surfacing must be utilized in applicable areas. Although a particular playground design may not meet the proposed Access Board Regulations in regards to the appropriate number of ground level events, the actual playground may be in compliance when considering existing play components.

Not all equipment may be appropriate for all children, even when designed for a target age group. To avoid injury you should closely supervise and participate in the child's use of this equipment, especially while learning to use it. Proper supervision is required.



Designed by: Trey Socash  
Certified Playground Safety Inspector

6-28-2019 Drawing 4

Danny's Love, Life, Adventure

**RESIDENTIAL**





7577 E. Main St, Lima NY 14485  
877-807-7529 (p) 585-624-7590 (f)  
info@bearsplaygrounds.com

Brandon, SD 57005

Attn: Contact Name  
E-Mail  
Phone #  
Alternate

Additional Contact

CPSC now recommends a minimum of 9" of loose fill safety surfacing material be installed and maintained in the use zone for safety. Safety surfacing package is to be "by others" unless specially included for an optional extra charge at the time of order. Acceptance of this proposal means that you accept Bears Playgrounds terms and conditions as described on the web site [www.bearsplaygrounds.com](http://www.bearsplaygrounds.com)

The Americans with Disabilities Act (ADA) may require that you make your park and / or playground accessible when viewed in it's entirety. Please consult your legal counsel to determine if the ADA applies to you. For playground equipment to be considered accessible, accessible surfacing must be utilized in applicable areas. Although a particular playground design may not meet the proposed Access Board Regulations in regards to the appropriate number of ground level events, the actual playground may be in compliance when considering existing play components.

Not all equipment may be appropriate for all children even when designed for a target age group. To avoid injury you should closely supervise and participate in the child's use of this equipment, especially while learning to use it. Proper supervision is required.



Designed by: Trey Socash  
Certified Playground Safety Inspector

6-28-2019 Drawing 4

Danny's Love, Life, Adventure

**RESIDENTIAL**





7577 E. Main St, Lima NY 14485  
877-807-7529 (p) 585-624-7590 (f)  
info@bearsplaygrounds.com

Brandon, SD 57005

Attn: Contact Name  
E-Mail  
Phone #  
Alternate

Additional Contact

CPSC now recommends a minimum of 9" of loose fill safety surfacing material be installed and maintained in the use zone for safety. Safety surfacing package is to be "by others" unless specially included for an optional extra charge at the time of order. Acceptance of this proposal means that you accept Bears Playgrounds terms and conditions as described on the web site [www.bearsplaygrounds.com](http://www.bearsplaygrounds.com)

The Americans with Disabilities Act (ADA) may require that you make your park and / or playground accessible when viewed in it's entirety. Please consult your legal counsel to determine if the ADA applies to you. For playground equipment to be considered accessible, accessible surfacing must be utilized in applicable areas. Although a particular playground design may not meet the proposed Access Board Regulations in regards to the appropriate number of ground level events, the actual playground may be in compliance when considering existing play components.

Not all equipment may be appropriate for all children even when designed for a target age group. To avoid injury you should closely supervise and participate in the child's use of this equipment, especially while learning to use it. Proper supervision is required.



Designed by: Trey Socash  
Certified Playground Safety Inspector

6-28-2019 Drawing 4

Danny's Love, Life, Adventure

**RESIDENTIAL**





7577 E. Main St, Lima NY 14485  
877-807-7529 (p) 585-624-7590 (f)  
info@bearsplaygrounds.com

Brandon, SD 57005

Attn: Contact Name  
E-Mail  
Phone #  
Alternate

Additional Contact

CPSC now recommends a minimum of 9" of loose fill safety surfacing material be installed and maintained in the use zone for safety. Safety surfacing package is to be "by others" unless specially included for an optional extra charge at the time of order. Acceptance of this proposal means that you accept Bears Playgrounds terms and conditions as described on the web site [www.bearsplaygrounds.com](http://www.bearsplaygrounds.com)

The Americans with Disabilities Act (ADA) may require that you make your park and / or playground accessible when viewed in it's entirety. Please consult your legal counsel to determine if the ADA applies to you. For playground equipment to be considered accessible, accessible surfacing must be utilized in applicable areas. Although a particular playground design may not meet the proposed Access Board Regulations in regards to the appropriate number of ground level events, the actual playground may be in compliance when considering existing play components.

Not all equipment may be appropriate for all children, even when designed for a target age group. To avoid injury you should closely supervise and participate in the child's use of this equipment, especially while learning to use it. Proper supervision is required.



Designed by: Trey Socash  
Certified Playground Safety Inspector

6-28-2019 Drawing 4

Danny's Love, Life, Adventure

**RESIDENTIAL**





7577 E. Main St, Lima NY 14485  
877-807-7529 (p) 585-624-7590 (f)  
info@bearsplaygrounds.com

Brandon, SD 57005

Attn: Contact Name  
E-Mail  
Phone #  
Alternate

Additional Contact

CPSC now recommends a minimum of 9" of loose fill safety surfacing material be installed and maintained in the use zone for safety. Safety surfacing package is to be "by others" unless specially included for an optional extra charge at the time of order. Acceptance of this proposal means that you accept Bears Playgrounds terms and conditions as described on the web site [www.bearsplaygrounds.com](http://www.bearsplaygrounds.com)

The Americans with Disabilities Act (ADA) may require that you make your park and / or playground accessible when viewed in it's entirety. Please consult your legal counsel to determine if the ADA applies to you. For playground equipment to be considered accessible, accessible surfacing must be utilized in applicable areas. Although a particular playground design may not meet the proposed Access Board Regulations in regards to the appropriate number of ground level events, the actual playground may be in compliance when considering existing play components.

Not all equipment may be appropriate for all children, even when designed for a target age group. To avoid injury you should closely supervise and participate in the child's use of this equipment, especially while learning to use it. Proper supervision is required.



Designed by: Trey Socash  
Certified Playground Safety Inspector

6-28-2019 Drawing 4

Danny's Love, Life, Adventure

**RESIDENTIAL**



custom. nature inspired. cedar log playgrounds.



**BEARS**  
bearsplaygrounds.com



Bears Playgrounds' nature-inspired products and natural materials help stimulate a child's imagination and enthusiasm for outdoor play. Their products facilitate learning, help build social skills, create opportunities for exercise, and by virtue of unique designs and materials, provide children with a connection to nature.

Bears Playgrounds' products are strong and durable, however, **there are natural aesthetics of real log products of which you should be aware.** Cedar logs have a fat end and a skinny end like a tree (instead of a manufactured dowel), **they have gorgeous wood grain, checking, knots, crooks, grooves, curves, even the occasional stubborn piece of bark, etc.** Those who are familiar with log construction know that it is subject to the natural process of "checking".



**Checking, or cracks, occur across or through the growth rings as they release moisture.** This is a natural process and is common to all wood species. Checking is not a defect in the wood; it does not diminish the quality, durability, safety, or the structural integrity. Instead, it is considered a part of the log's rustic natural look and adds to the uniqueness of each piece.

Your products will have checking!

We want to ensure your satisfaction with these nature-inspired products. Please call us with any questions, suggestions, or concerns.

877-807-7529

info@bearsplaygrounds.com