

## Vala's Pumpkin Patch

12102 South 180th Street  
 Gretna, NE 68028-5802

Charlie  
 valas.pumpkin@gmail.com  
 Project: Dreamin Big  
**6-24-2011 drawing 4**  
 Ages 5-12  
 Designed by: Marcye Bears  
 & Danny Bears  
 Certified Playground Safety Inspector

CPSC now recommends a minimum of 9" of loose fill safety surfacing material be installed and maintained in the use zone for safety. Safety surfacing package is to be "by others" unless specially included for an optional extra charge at the time of order. Acceptance of this proposal means that you accept Bears Playgrounds terms and conditions as described on the web site [www.bearsplaygrounds.com](http://www.bearsplaygrounds.com)

The Americans with Disabilities Act (ADA) may require that you make your park and / or playground accessible when viewed in it's entirety. Please consult your legal counsel to determine if the ADA applies to you. For playground equipment to be considered accessible, accessible surfacing must be utilized in applicable areas. Although a particular playground design may not meet the proposed Access Board Regulations in regards to the appropriate number of ground level events, the actual playground may be in compliance when considering existing play components.

Not all equipment may be appropriate for all children, even when designed for a target age group. To avoid injury you should closely supervise and participate in the child's use of this equipment, especially while learning to use it. Proper supervision is required.

**ADA REQUIRES ADDITIONAL GROUND LEVEL COMPONENTS NUMBER REQUIRED 4 OF 3 DIFFERENT TYPES**

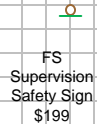
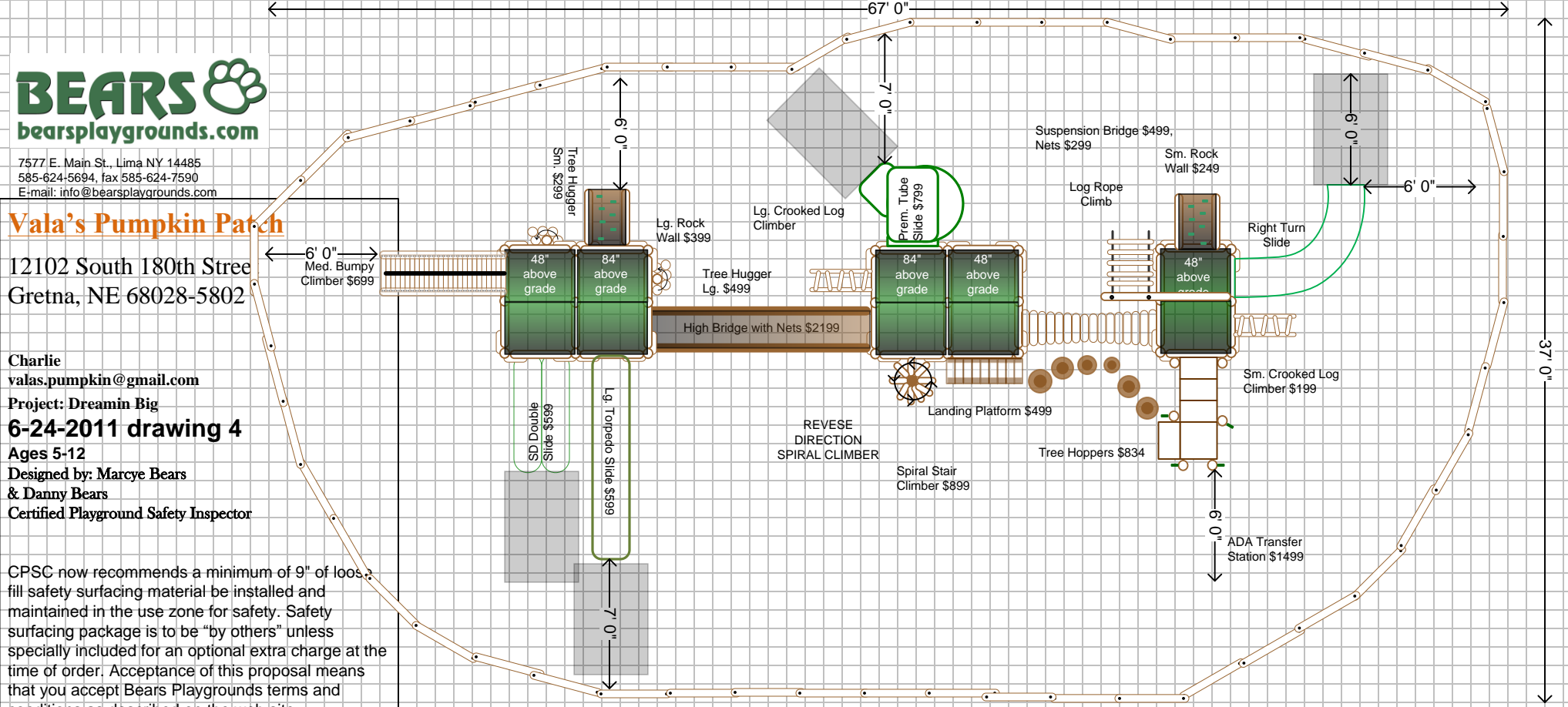

### Include

Wooden Roof Upgrade \$399 per

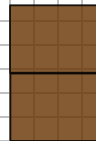

Wooden rail Upgrade \$50 each



### Consider Adding

4' x 6' heavy duty slide mats.

ADA Transfer Station \$1499

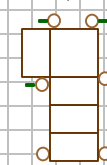

ADA Transfer Station \$1499

